

Technical Manual

IS6C Performance™ Series



ACOUSTIC & ELECTRICAL SPECIFICATIONS:

- Nominal Impedance 8 Ohms
- Max Amp Power 80 Watts*
- Frequency Response 40Hz – 20kHz (-10dB)
- Sensitivity 88dB (2.83V @ 1 meter)
- Crossover Frequency 2,600Hz

SYSTEM COMPONENTS:

- Grille, Gray 590-0271
- Low-Frequency Transducer 6-1/2" (165mm) Titanium-laminate cone w/rubber surround (590-0285)
- DC Resistance 6.2 Ohms, ±10%
- High-Frequency Transducer 1" (25mm) Titanium-laminate dome, w/swivel mount (590-0287)
- DC Resistance 7.6 Ohms, ±10%
- Crossover Network 590-0286

AURAL SWEEP TEST SPECIFICATIONS:

- System Aural Sweep Test 6.0V Input 40Hz to 20kHz
- L.F. Aural Sweep Test 5.0V Input 40Hz to 4kHz
- H.F. Aural Sweep Test 2.83V Input 2kHz to 20kHz

PHYSICAL SPECIFICATIONS:

- Plate Size (Diameter) 9-3/16" (233mm)
- Mounting Cutout Size (Diameter) 7-7/8" (200mm)
- Mounting Depth 4-1/4" (108mm)
- Weight 8 lb/3.7kg (sold in pairs)

WARRANTY:

- Refer to Warranty Statement packed with each product.

* The maximum recommended amplifier power rating will ensure proper system headroom to allow for occasional peaks. We do not recommend sustained operation at these maximum power levels.

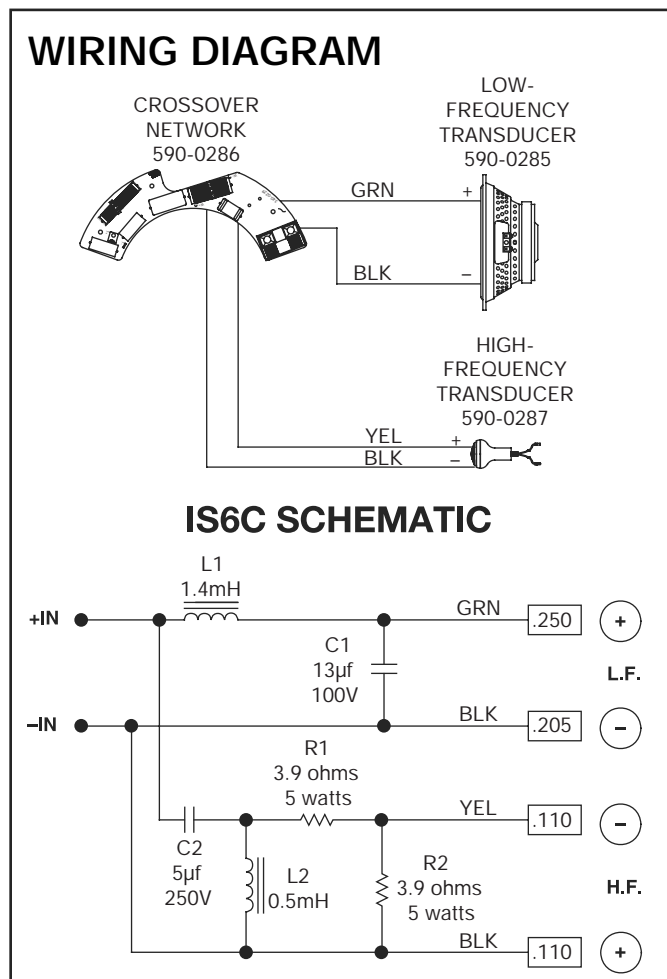
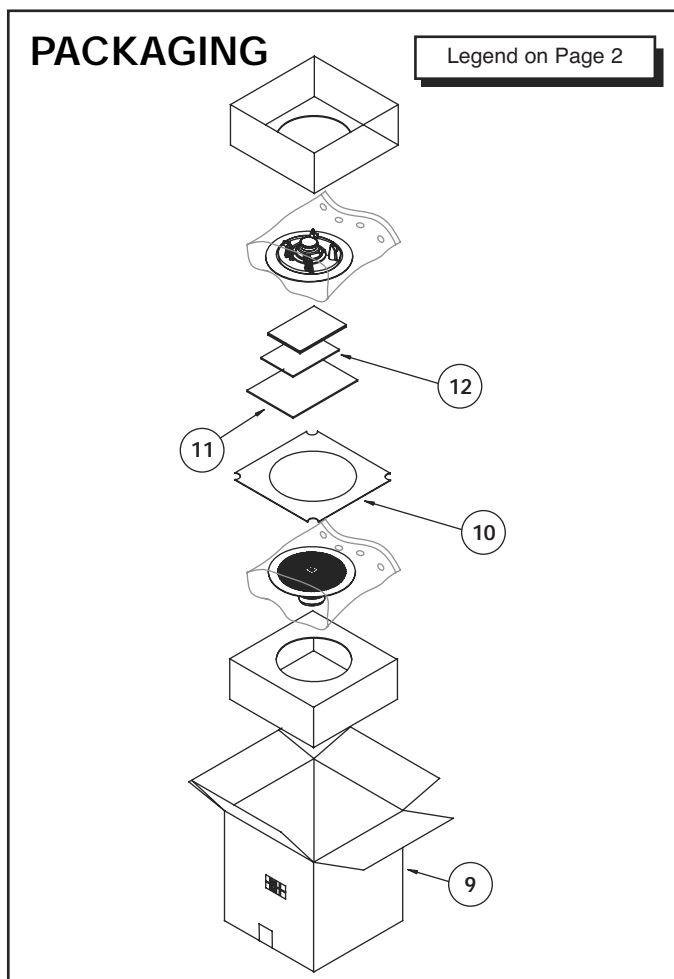

IS6C Performance™ Series



EXPLODED VIEW

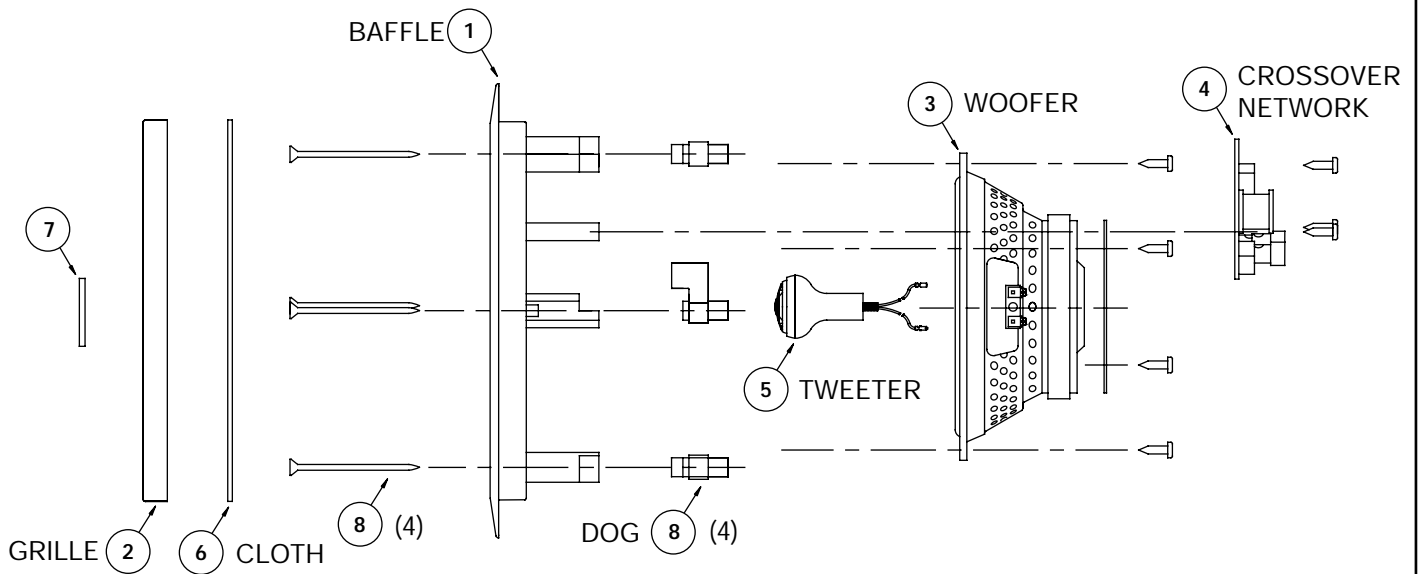

ITEM NO.	PART NO.	DESCRIPTION
1	590-0192	BAFFLE IS6C
2	590-0271	GRILLE ASS'Y
3	590-0285	6-1/2" WOOFER
4	590-0286	CROSSOVER NETWORK
5	590-0287	1" TWEETER
6	GRILLE CLOTH	not sold alone – 590-0271
7	180-0030	JBL LOGO
8	590-0173	DOG EAR W/SCREW
9	220-0740	OUTER CARTON
10	220-0443	TEMPLATE
11	170-1034	OWNER'S MANUAL
12	N/A	WARRANTY CARD

IS6C ROUGH-IN FRAME part #RIF6C

IS6C Performance™ Series